

200x200 VESA Adaptor Plate

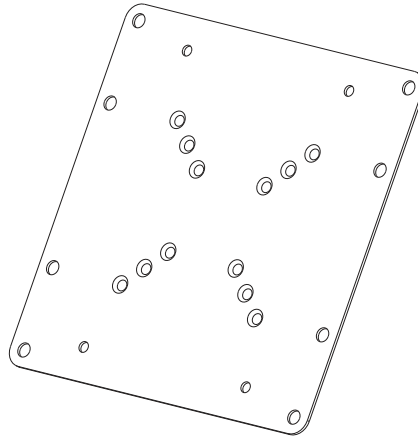

COMPONENT CHECKLIST

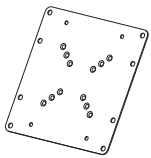

A
Plate
(x1)



B
Countersunk
Screw
M5x10mm
(x4)



C
M5
Nylock
Nut
(x4)



D
Screw
M6x14mm
(x4)

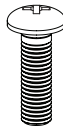

E
Screw
M8x20mm
(x4)



F
Screw
M4x12mm
(x4)



G
Screw
M4x10mm
(x4)



H
Nut
M4
(x4)



I
Washer
M5
(x4)



J
Spacer
M8 x 5mm
(x8)



K
Washer
M8
(x4)



REQUIRED TOOLS

- Phillips Head Screwdriver
- 7mm Spanner

WEIGHT RANGE

0 - 30kg
(0 - 66lbs)

Monitor weight should be within the weight range of all modular elements that make up the complete monitor mounting solution.

IMPORTANT INFORMATION

- ! **Please ensure this product is installed as per these installation instructions.**
- ! The manufacturer accepts no responsibility for incorrect installation.
- ! Flush Configuration - Recommended for greater than 12kg (26.5lbs)
- ! Spacer Configuration - Suitable for all load unable to be flush mounted
- ! This product reduces the working capacity of the monitor arm by 1kg (2.2lbs).
- ! Maximum load for plate only is 30kg (66lbs).
- ! Curved monitors, deep devices (such as all-in-one PCs), VESA mounted accessories (such as mini PC brackets and mounts), and offset VESA locations exert additional leverage that can exceed the capacity of the mount even though the monitor weight may be within the stated range. Please contact Atdec if you would like further information.

Flush mounting configuration (Suitable for M5 clearance hole sizes)

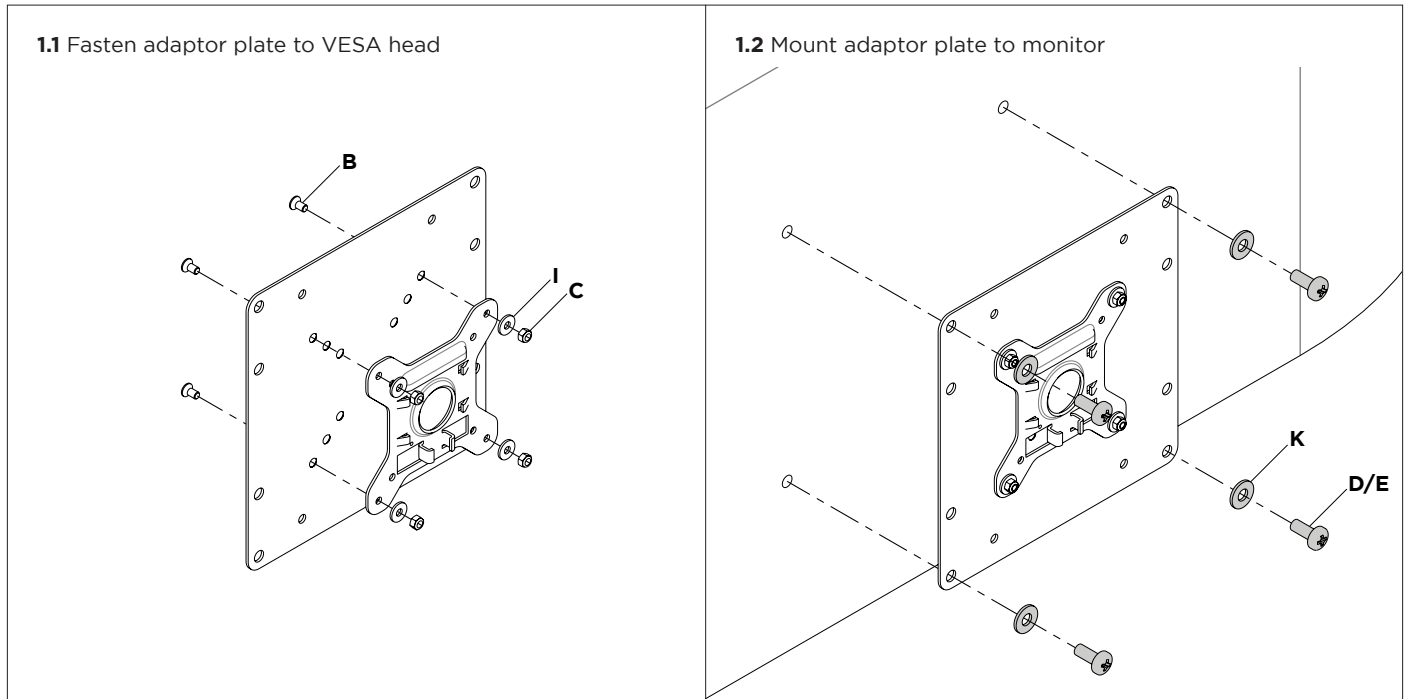

Spacer configuration (Suitable for M4 clearance hole sizes)

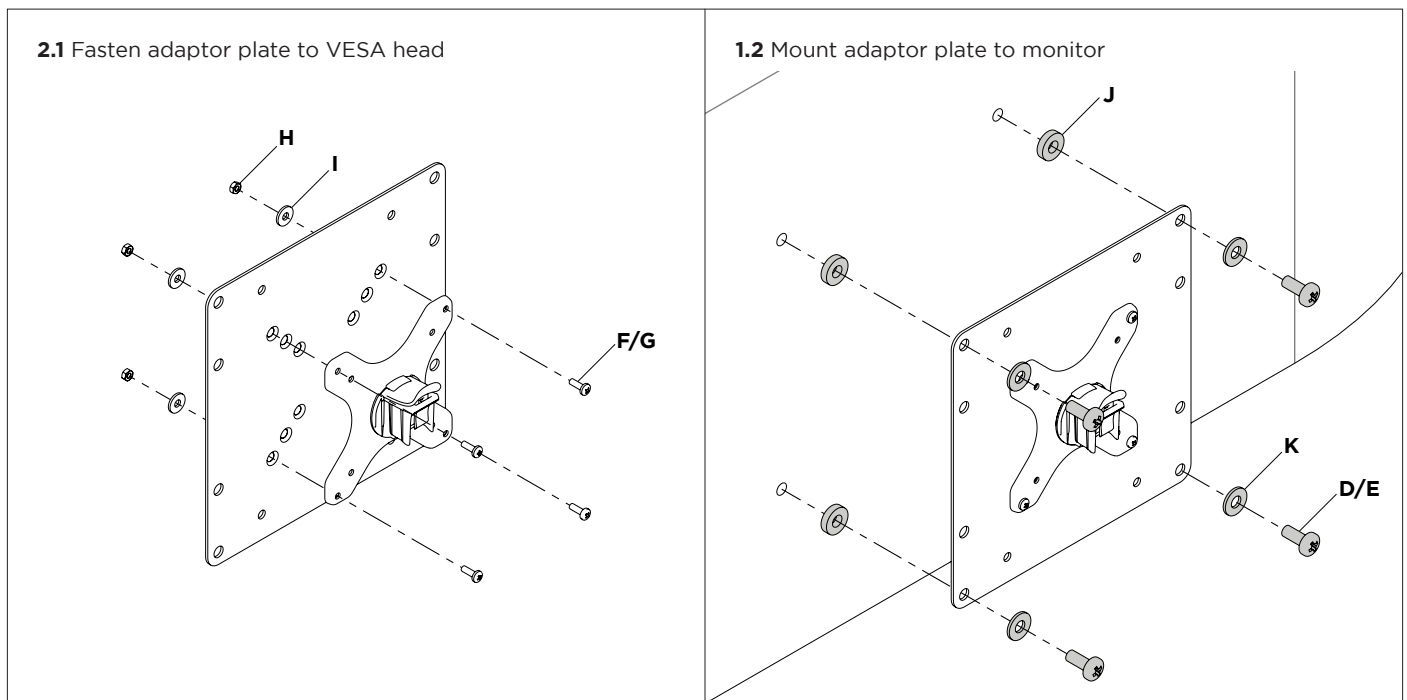

3. Check fitment

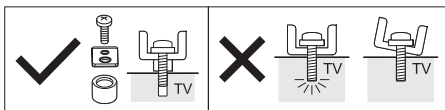

NOTE:

- Ensure the display brackets are not loose and screws are not forced too deep into the display.
- If spacers are needed, use the shortest possible combination between the display bracket and the display.

